

TWAIN CENTER

4401 Twain Ave., #31



Approx. 720 sf.
Warehouse w/ Office



Rate: 1.18/foot or
\$850/month industrial gross

Term: 1-3 years

Available: Now

Description: Reception, two offices, break counter w/sink, small warehouse with 10x10 grade level truck door, a/c in offices. Common restrooms in complex.

For more information call:

858.272.7070

Joan Barnes

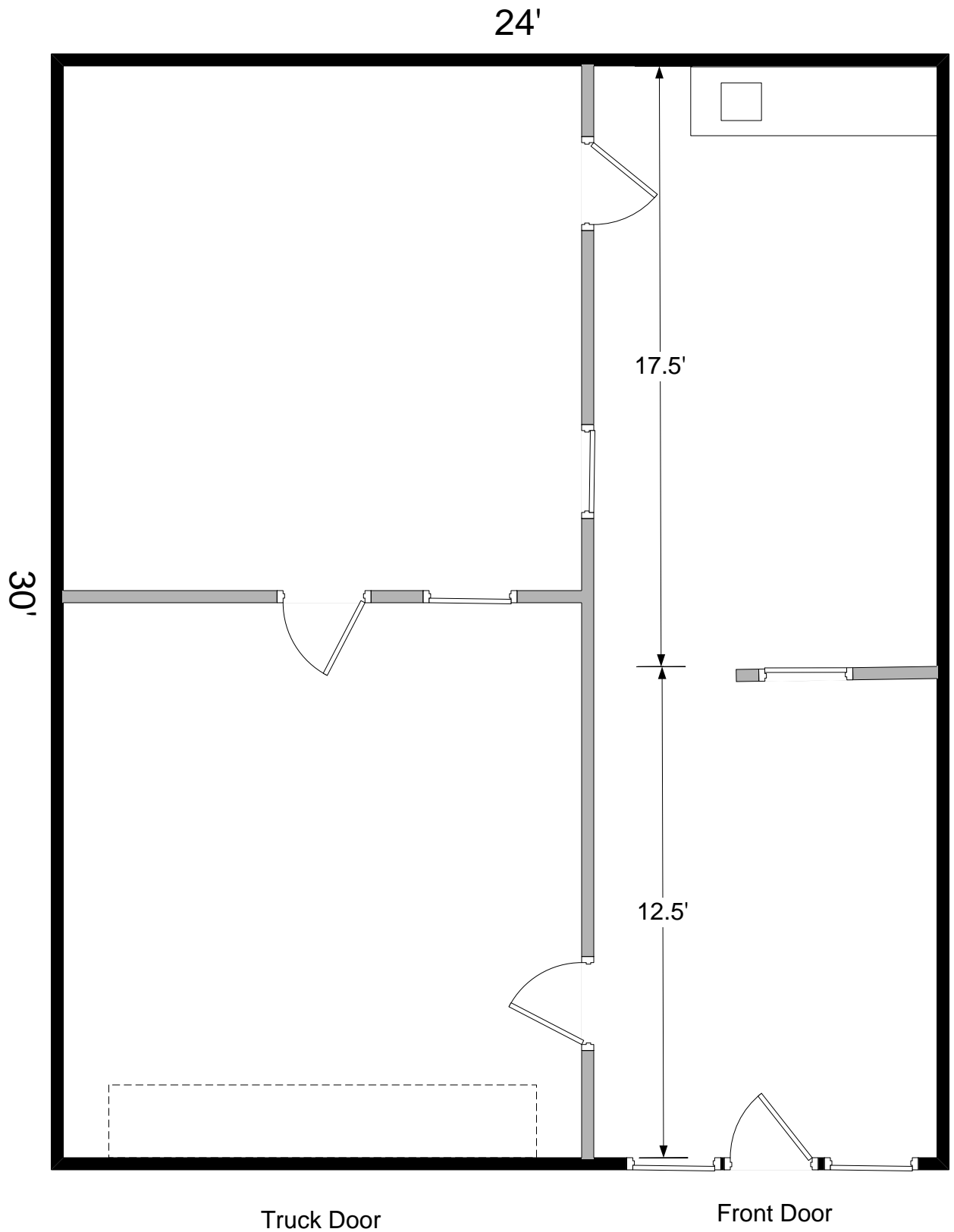

Truck Door

Front Door



4401 Twain Ave. #31 - 720 SF

Joan Barnes – (858) 272-7070